

Peeling machine CSM-20 / MSM-20



Operating principle

The Sormac carborundum peeler and Sormac knife peeler are ideal for peeling of root products such as potatoes, kohlrabi and celeriac.

In the carborundum version (CSM-20) the machine has a carborundum covered interior and a carborundum disc. The peeling disc can be taken out and is designed to enable the product to rotate within the machine. This allows the product to be peeled evenly around.

In the knife peeling version (MSM-20), the product is knife peeled to obtain a smooth surface. Any potential bruising and peeling losses are greatly reduced thanks to precision knife adjustment and the rubber skin inside the drum.

The construction is very compact with the motor inside the machine. For cleaning purposes the machine is equipped with legs. These adjustable legs can be supplied in different sizes.

Capacity

15 - 20 kg per cycle. The cycle time is 1 - 5 minutes. The capacity of the peelers is dependent on the product and the desired peeling waste percentage.

When from potatoes in a CSM-20 carborundum peeler about 40% will be peeled off, at a switching time of 15 seconds between two fillings, the capacity will be approx. 300 kg per hour net product. With 50% peeling, the capacity will be approx. 200 kg per hour net product (see table backside).

Options

- > pneumatic door operation, for use in an automatic production line
- > adjustable legs

Features

- > removable knife peeling disc with 15 long and 15 short peeling knives (MSM-20)
- > knife disc of stainless steel with milled knife cavities
- > knife disc with 3 robust turning rubbers

Product specification

These peelers are suitable for peeling potatoes, celeriac, kohlrabi etc.

Technical data

| | | |
|-------------------|-----------------------|-----------------------|
| Type: | CSM-20 | MSM-20 |
| Execution: | carborundum C16 | knives |
| Voltage: | 400 V, 50 Hz, 3 phase | 400 V, 50 Hz, 3 phase |
| Installed power: | 1,1 kW | 1,1 kW |
| Speed: | 190 RPM | 190 RPM |
| Dimensions WxDxH: | 595 x 850 x 1.050 mm | 595 x 750 x 1.050 mm |
| Infeed height: | 990 mm | 990 mm |
| Outfeed height: | 500 mm | 500 mm |

The machines can peel off per hour as follows (indicative):

| | | | |
|------------|----------|----------|---------------------|
| | CSM-20 | MSM-20 | recommended filling |
| Potatoes: | 220 kg/h | 90 kg/h | 20 kg |
| Carrots: | 180 kg/h | 50 kg/h* | 20 kg |
| Kohlrabi: | 80 kg/h | 50 kg/h* | 15-20 kg |
| Celeriac: | 50 kg/h | 15 kg/h* | 15 kg |
| Red beets: | 120 kg/h | 40 kg/h | 20 kg |

* not recommended

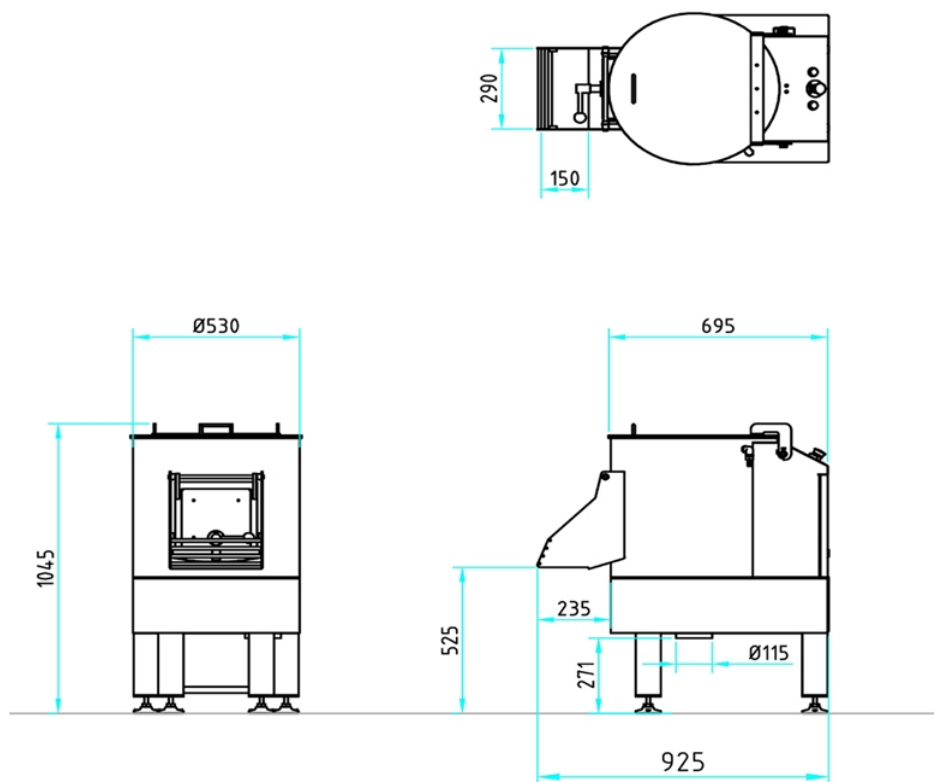

Sormac B.V.

P.O. Box 419
NL-5900 AK Venlo

Telephone: +31 (0)77 351 84 44
Fax: +31 (0)77 320 48 01

Huiskensstraat 68
NL-5916 PN Venlo

E-mail: info@sormac.nl
Internet: www.sormac.nl

Alterations reserved